

ALERVITES

AT2 Two-way Radio

Please read this manual carefully before using the product and retain it for future reference.

USER'S MANUAL

Radio Overview

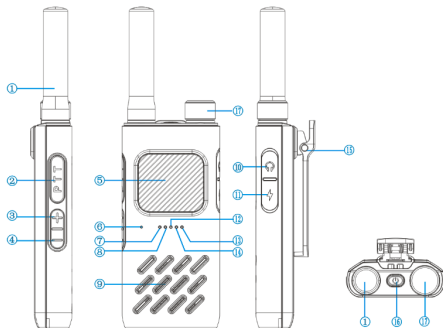

- | | |
|-------------------------------|--------------------------------------|
| 1. Antenna | 10. Headset/Programming port |
| 2. PTT button | 11. Type-C charging port |
| 3. Volume up/Monitor | 12. Bluetooth indicator (blue light) |
| 4. Volume down/Menu | 13. Charging complete (white light) |
| 5. PTT button | 14. Charging in progress (red light) |
| 6. Microphone | 15. Belt clip |
| 7. TX indicator (red light) | 16. Power switch/Exit key |
| 8. RX indicator (green light) | 17. Encoder/Menu list toggle |
| 9. Built-in speaker | |

Keys

	Press	Press and hold
SK1	Increase volume (1 step)	Monitor Function
SK2	Decrease volume (1 step)	Menu Mode/Confirm Button
Top power button	Exit menu	Power On/Off

Status Indications

The top LED will help you to identify the current radio status.

	Always on	Not lit	Flashing
⁷ Red light	Transmitting...	Standby	-----
⁸ Green light	Receiving...	Standby	Scanning
¹² Blue light	Bluetooth enabled	Bluetooth off	Bluetooth disconnected
¹³ Red light	Charging...		-----
¹⁴ White light	Charging complete		Battery failure (no battery detected)

| Packing List

Welcome to ALEVITES Two-way Radio. Before use, we recommend:

Please unpack carefully and check that you have received the following items. If any item is missing or damaged, contact your dealer.

Item	Quantity (PCS)
Radio	1
Battery	1
Charge Cable	1
Belt Clip	1
User Manual	1

Note: Figures in this manual are for reference only.

| Before Use

1. Attaching the Battery

- a. Use the approved battery to avoid the risk of explosion.
- b. Dispose of the used battery according to "Precautions for Disposal" in the Safety Information Booklet.

2. Attaching the Belt Clip

Align the belt clip bracket with the clip slot on the back of the radio. Slide it downward until the clip locks into place.

To remove, press the locking pivot on the clip to disengage it, then slide the clip upward until it separates from the radio.

3. Attaching the Audio Accessory

Open the audio jack cover, and then insert the audio accessory into the jack.

4. Charging the Battery

Use the approved charger to charge the battery.

NOTE: The remaining lithium-ion battery power is limited to 30% pursuant to the new lithium battery shipment regulation approved by the International Air Transport Association (IATA).

Before initial use, charge the battery.

Use the USB Type-C charge cable to connect the radio with battery attached to the power adapter, power bank, or PC.

When powered off, the indicator light glows red during charging and turns green when fully charged.

When powered on, the top notification bar's battery icon displays green during charging, the top indicator glows red, and it switches to green once fully charged.

| Basic Operations

1. Turn the Radio On and Off

Press and hold the  key to turn the radio on or off.

- Turning the radio on will be accompanied by the voice prompt “Power on” and show the current channel.
- Turning the radio off will be accompanied by the voice prompt “Power off”.

2. Eight-level Volume Adjustment.

- Press the SK1 key (I+) to increase the volume by one level each time.
- Press the SK2 key (-) to decrease the volume by one level each time.

3. Channel Selection

Rotate the channel knob to select channels. Turning clockwise changes the channel incrementally by one. Turning counterclockwise decreases the channel incrementally by one.

- 1) Voice announcement of channel sequence. For digital channels, prompts “Digital”.
- 2) Empty Channel (Unedited Parameters) Alert Prompt.

4. Call Service

Making a Call

- Rotate the channel knob to select a channel, then press and hold the PTT button to initiate a call. The red indicator will light up.
- Release the PTT button and wait to receive the call.

Receiving Calls

- For analog calls, the RX indicator illuminates solid green.
- For digital calls, the RX indicator illuminates solid amber (combination of red and green lights).

Dual PTT Transmission Function

1) The PTT button on the left side of is the Main PTT, which always transmits and receives on the main channel.

2) The PTT button on the front of is the sub-PTT:

- When the sub-PTT is set to follow the PTT channel, it functions identically to the Main PTT, transmitting on the current channel.
- When the sub-PTT is set to a designated channel, it always transmits on the preset channel. The radio enables dual-channel monitoring, simultaneously monitoring the main channel (current channel) and the channel associated with the sub-PTT.

5. Monitor

Press and hold [SK1] (Monitor function) to keep the speaker to disable squelch and listen for faint signals. Release to exit monitoring mode.

6. Frequency Sweep Function

- Rotate the channel knob to Channel 1 and turn off the radio.
- Press and hold the 【PTT】 + 【SK1】 keys to power on. The voice prompt “On (Frequency Sweep Function On), Power On” will sound, entering the sweep function with the green LED flashing. Press the 【SK1】 key once; a “beep” will sound and the green LED will turn solid, initiating the sweep. Upon completion, the scanned frequency will be automatically stored with two “beep” tones. (The green LED remains solid during scanning and flashes when scanning stops.)
- Rotate the channel knob to Channel 2. Briefly press 【SK1】 to resume scanning. After completion, the frequency will be automatically stored with two “beep” tones. The LED indicators function as described above.
- Rotate the channel knob to Channel 3 and briefly press 【SK1】 to continue scanning. Upon completion, the frequency will be automatically stored with a “beep-beep” tone prompt. Repeat this process sequentially up to Channel 16.
- After completing the scanning task, power off and restart to exit scan mode, concluding the scanning operation.

7. Wireless Cloning Function

- Set the receiver and transmitter to Channel 2 and turn them off.
- Press and hold PTT + SK1 while powering on both units to enter cloning mode.
- Press the transmitter's [PTT] button. The red light stays on, and the receiver's green light automatically stays on. All configuration parameters for channels 1-16 on the receiver are copied. The transmitter beeps twice (“beep-beep”) to indicate copying is complete. Both units' indicator lights turn off, automatically powering back on. The copying task is finished.

8. Low Battery Warning

The low battery warning alerts you that the battery requires recharging.

If the battery level drops to a predetermined threshold during transmission, the radio will emit a “Please replace battery” tone every 10 seconds. When the beep sounds, the radio will cease transmission.

| Menu Functions

Press and hold [SK2] to enter the menu. Use the encoder to navigate and [SK2] to confirm/save. Briefly press the top power button to exit menu mode. If no menu operation occurs within 30 seconds, the device will automatically exit menu mode.

Transmit Power

Rotate the encoder until the voice prompt announces “High Power” (current power state). Briefly press [SK2] to confirm. Rotate the encoder to toggle between “High Power” and “Low Power”. Briefly press [SK2] to confirm and return to the main menu. Briefly press the top power button to exit the menu.

Channel Type

Rotate the encoder until the voice prompt announces “Analog Channel” (current channel type). Briefly press the [SK2] key to confirm. Rotate the encoder to toggle between “Analog Channel” and “Digital Channel”. Briefly press the [SK2] key to confirm and return to the main menu. Briefly press the top power button to exit the menu.

Voice Activation Switch

Rotate the encoder until the voice prompt says “VOX Off” (current voice control status). Briefly press the [SK2] key to confirm. Rotate the encoder to toggle between “VOX On” and “VOX Off”. Briefly press the [SK2] key to confirm and return to the main menu. Briefly press the top power button to exit the menu.

Bluetooth Switch

Rotate the encoder until the voice prompt “Bluetooth On” (current Bluetooth status) is heard. Briefly press the [SK2] key to confirm. Rotate the encoder to toggle between “Bluetooth On” and “Bluetooth Off”. Briefly press the [SK2] key to confirm and return to the main menu. Briefly press the top power button to exit the menu.

Enable Bluetooth functionality; the Bluetooth indicator (blue light) illuminates. This enables pairing with compatible terminal devices via the app. In radio mode, configure:

1) Channel parameters: Frequency, Sub-tone, Occupied Bandwidth, Frequency Hopping, Talk Mode, Key.

2) Radio functions: Squelch Level, Voice Switch, Power-Saving Mode, Prompt Tone, Noise Reduction Switch, Voice Activation Switch, and Voice Activation Level.

Scanning Activation

Rotate the encoder until the voice prompt “Scanning” is heard. Briefly press SK2 to confirm. The voice prompt “Scanning Started” will sound, and scanning will begin (configure scanning and add channels via the app). Press the top power button to exit scanning.

TEST: Did not enter scan function. During scanning, the device cycles through channels in the scan list with the indicator light flashing slowly.

Channel Memory Access

Rotate the encoder until the voice prompt “Channel Memory” is heard. Press SK2 briefly to confirm. The voice will announce the current channel memory information (receive/transmit frequency, transmit power, sub-tone, etc.). Press SK2 briefly to replay. Press the top power button briefly to exit the menu.

TEST: Sub-audio announcement abnormal (announces “analog”; normal is “analog sub-audio and value”)

Battery Level Access

Rotate the encoder until the voice prompt says “High battery” (current battery status). Press SK2 briefly to replay. Press the top power button briefly to exit the menu.

| Download the App

Scan the QR code on the front page of the manual or visit the download links:

Android: <https://play.google.com/store/apps/details?id=com.aewt.app.friends>

iOS: <https://apps.apple.com/us/app/ola-radio/id6740220159>

User Registration

Open the App (Ola Radio), enter your mobile phone number, or authorize a third-party application to complete the user registration.

Binding the Device

1. Turn on the walkie-talkie, and double-click the power button to turn on the Bluetooth function. The walkie-talkie will play a voice prompt, and the blue LED will flash.
2. In the app, go to the "Device" page, and tap **[Add Device]** to proceed to the Bluetooth page.
3. The app will search for and detect the AT2, then pop up an AT2 information card. Tap "Connect Device" to bind the device.
4. After successful binding, it will automatically return to the Device page and display the AT2 device information.

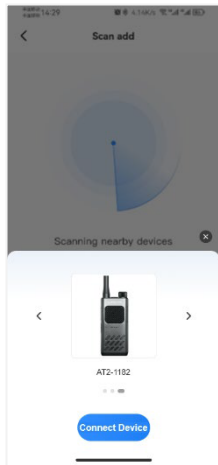
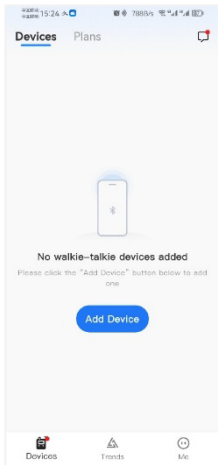

| Bluetooth Control

1. Power on the radio and enable Bluetooth to establish a connection with the app. Tap the "AT2" device card and select "Bluetooth Control" to enter the control interface.
2. Tap any channel button at the bottom to switch the walkie-talkie to that channel. Tap the settings icon in the upper right corner of a channel to edit its parameters.
3. Tap the [Batch Settings] button to configure parameters for multiple channels at once.
4. Tap the [Switch List] button to go to the channel list and view all channel parameters. On the list page, tap "Back" to return to the control page.
5. Tap the [Function Switch] button to enter the function parameter settings page. Tap the corresponding parameter to toggle it on/off or adjust its settings.
6. Tap the [...] icon in the upper right corner to open the menu, and select [Save Profile]. This saves the current walkie-talkie configuration parameters as a profile file, making it convenient to reuse the channel and function parameters on other devices.
7. Tap the [...] icon in the upper right corner to open the menu, and select [Factory Reset] to restore the walkie-talkie to its default factory settings.

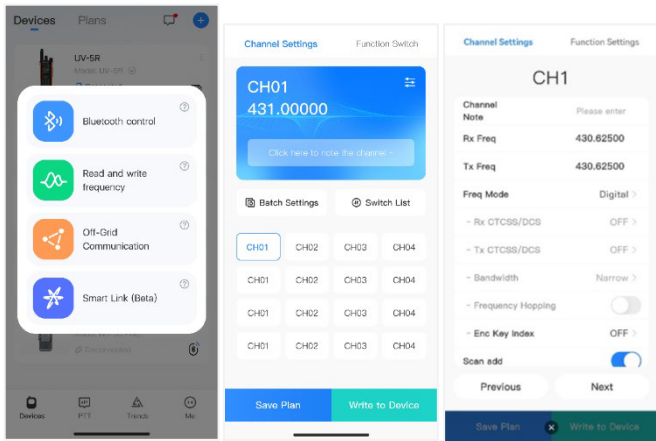

Wireless Programming

1. Power on the radio and enable Bluetooth to establish a connection with the app. Tap the "AT2" device card and select "Wireless Programming" to enter the Device Reading page.

2. Wait a few seconds, the interface will populate with all channel and function parameters currently stored on the connected device. Review these settings by switching between tabs or scrolling vertically through the list.

3. Tap [Edit Configuration] to enter the Device Parameter Editing - Channel Settings page.

4. Tap any channel button at the bottom to select a channel. Tap the settings icon in the upper right corner of the channel to edit.

5. Tap the [Batch Settings] button to generate or modify multiple channels at once.

6. Tap the [Switch List] button to go to the channel list and view all channel parameters. On the list page, tap "Back" to return to the control page.

7. Tap the [Function Switch] button to enter the function parameter settings page. Tap the corresponding parameter to toggle it on/off or adjust its settings.

8. Tap the [...] icon in the upper right corner to open the menu, and select [Factory Reset] to restore the walkie-talkie to its default factory settings.

9. Tap the [...] icon in the upper right corner to open the menu, and select [Apply to Other Models]. You can select a different device model and synchronize all parameters to

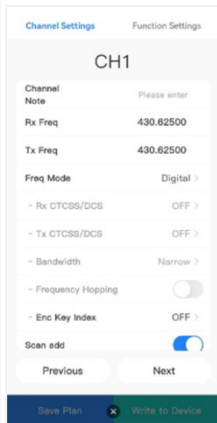
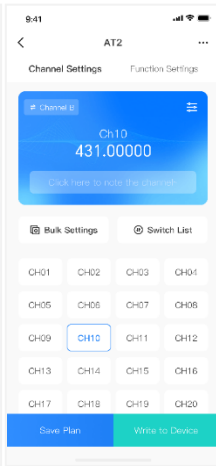
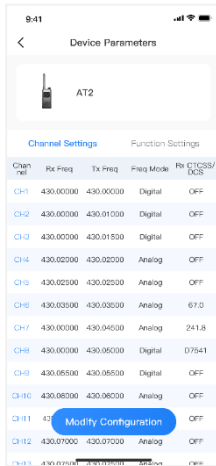

match that model's configuration.

10. Tap [Save Profile] at the bottom to save the current walkie-talkie configuration parameters as a profile file. This makes it convenient to reuse the channel and function parameters on other device models.

11. Tap [Write to Device] at the bottom to write all parameters into the walkie-talkie currently connected via Bluetooth.

Tip: All operations performed in Bluetooth Control mode take effect immediately.

| Off-Grid Communication

1. Power on the radio and enable Bluetooth to establish a connection with the app. Tap the "AT2" device card and select "Off-Grid Communication" to enter the offline chat list page.

2. Tap the text box at the bottom of the screen to enter text, then tap the [Send] button to send the message.

3. Tap the [+] icon in the lower right corner and select [Help] to open the list of preset help messages. You can quickly select a preset or edit your own, then tap to send the help message directly.

4. Tap the [+] icon in the lower right corner and select [Location]. This opens a pop-up displaying your current latitude and longitude coordinates to send as a location message.

5. Tap the [+] icon in the lower right corner and select [Photo]. Choose to take a picture or select one from your album, select the desired photo, and send it as a picture message.

6. Tap the [+] icon in the lower right corner and select [Microphone]. This opens a voice recording pop-up. Press and hold the microphone icon to start recording, and release it to send the voice message.

7. Tap the [Walkie-Talkie] icon in the lower left corner to enter real-time intercom mode. Here you can switch channels and adjust frequencies; press and hold the PTT button to directly initiate a transmission.

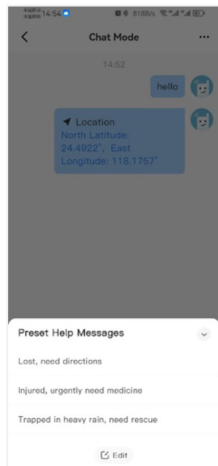
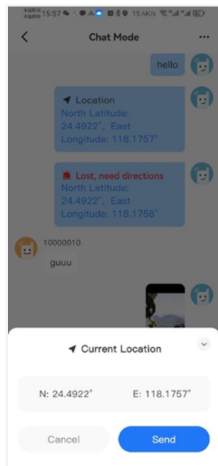
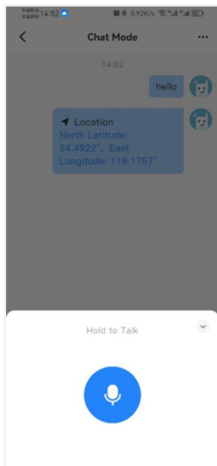
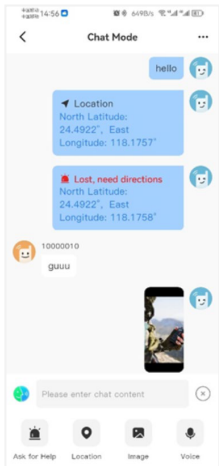

| Smart Link (Beta)

1. Power on the radio and enable Bluetooth to establish a connection with the app. Tap the "AT2" device card and select "Smart Link (Beta)" to enter the Smart Link Mode page.
2. Tap the switch in the upper right corner to enable "Smart Link Mode".
3. Tap the [Go to Connect] button in the lower left corner to jump to the phone's system Bluetooth settings page. Search for and pair with the Bluetooth device whose name uses the device name as a prefix and "Smart" as a suffix (e.g., DeviceName_Smart).
4. Tap the [PTT Settings] button in the lower right corner to open the "Main PTT Long Press Settings" pop-up window, and select a compatible third-party network intercom app.

Options	Description	Supported OS
Zello	For "Zello PTT" control	Android, Android native
	For "NSPTT" control	IOS、 Android
Others1	For "Totalk PTT" and "NSPTT" control	iOS, Android, HarmonyOS NEXT, Android Native
Others2		
Others3	For "Totalk PTT" control	Android, Android Native
Others4		

5. Button Functions:

Button	Action	Function
Main PTT	Short Press	Reject Call (Incoming Call)
	Long press	Network PTT (Configurable)
Sub PTT	Short Press	Answer Call (Incoming Call)
	Double click	Wake Mobile AI
	Long press	Network PTT

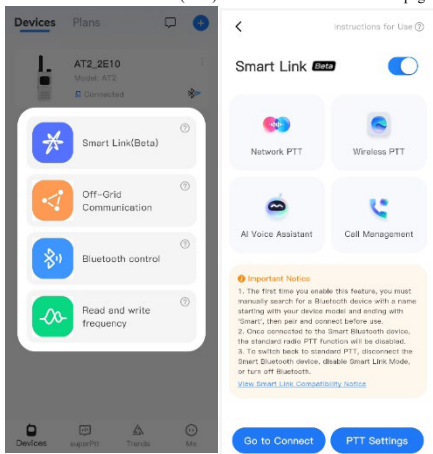

+ key	Short Press	Volume Up
- Key	Short Press	Volume Down

Note: This mode is an exploratory Beta feature. Due to the complex ecosystem of smartphones and apps, compatibility variations may exist. Once Smart Link Mode is enabled, the walkie-talkie's conventional radio intercom and Off-Grid Communication functions will be temporarily unavailable. Disabling Smart Link Mode will restore the standard intercom functions.

For more operating instructions on Smart Link Mode, please visit: <https://docs.qq.com/pdf/DUUFITERRdk9weFpB>



| Firmware Upgrade Tool

1. Open the app, tap the [...] icon on the right side of the "AT2" device card, and select "Device Details" to enter the Device Details page.
2. Tap the [Firmware Upgrade Tool] menu to open the download link menu. Copy any cloud drive URL, paste it into your computer's browser, and download the firmware upgrade software and the firmware package.
3. Turn off the walkie-talkie. Press and hold the [PTT + Volume Down] buttons, then press the power button to turn on the walkie-talkie and enter upgrade mode (the blue LED will remain solid).
4. Connect the walkie-talkie to the computer using a USB to Type-C data cable, then open the programming software. (When the walkie-talkie is in upgrade mode, the serial port status will display "Unknown - Not Connected").
5. Click [Firmware Upgrade] to open the firmware upgrade pop-up window, then click [Select File] to choose the downloaded .bin firmware file. Finally, click the [Start] button to begin writing the firmware. Wait until the screen displays "Firmware Upgrade Successful" to complete the process.

For more operating instructions on app functions, please visit: <https://docs.qq.com/pdf/DUWRZdHZid1JHZndX>



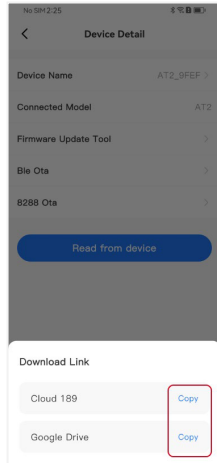
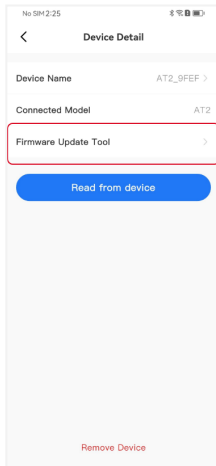
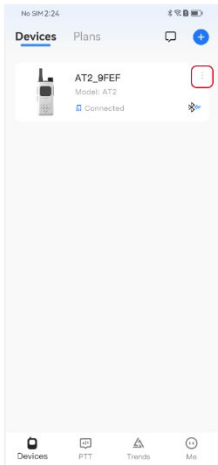

| Safety and General Information

WARNING:

Changes or modifications to this unit not expressly approved by the party responsible for compliance could void the user's authority to operate the equipment. This device complies with Part 15 of the FCC Rules. Operation is subject to the following two conditions: 1) This device may not cause harmful interference, and 2) this device must accept any interference received, including interference that may cause undesired operation.

NOTE: This equipment has been tested and found to comply with the limits for a Class B digital device, pursuant to Part 15 of the FCC Rules.

These limits are designed to provide reasonable protection against harmful interference in a residential installation. This equipment generates, uses and can radiate radio frequency energy and, if not installed and used in accordance with the instructions, may cause harmful interference to radio communications. However, there is no guarantee that interference will not occur in a particular installation.

If this equipment does cause harmful interference to radio or television reception, which can be determined by turning the equipment off and on, the user is encouraged to try to correct the interference by one or more of the following measures:

- Reorient or relocate the receiving antenna.
- Increase the separation between the equipment and receiver.
- Connect the equipment into an outlet on a circuit different from that to which the receiver is connected.
- Consult the dealer or an experienced radio/TV technician for help.

Safety Information for Radios

Your wireless handheld portable transceiver contains a low power transmitter. When the talk key is pushed, it sends out radio frequency (RF) signals. The device is authorized to operate at a duty factor not to exceed 50%. In August 1996, the Federal Communications Commissions(FCC) adopted RF exposure guidelines with safety levels for handheld wireless devices.

Important

FCC RF Exposure Requirements: For body-worn operation, this radio has been tested and meets the FCC RF exposure guidelines when used with Pofung accessories supplied or designated for this product. Use of other accessories may not ensure compliance with FCC RF exposure guidelines. Use only the supplied antenna. Unauthorized antennas, modifications or attachments could damage the transmitter and may violate FCC regulations.

Normal Position

Hold the transmitter approximately 2 inches from your face and speak in a normal voice, with the antenna pointed up and away.

FCC Part 15.21 Warning Statement-

NOTE: THE GRANTEE IS NOT RESPONSIBLE FOR ANY CHANGES OR MODIFICATIONS NOT EXPRESSLY APPROVED BY THE PARTY RESPONSIBLE FOR COMPLIANCE. SUCH MODIFICATIONS COULD VOID THE USER'S AUTHORITY TO OPERATE THE EQUIPMENT.

IC RSS-GEN

This device complies with Industry Canada license-exempt RSS standard(s). Operation is subject to the following two conditions:

- (1) this device may not cause interference, and
- (2) this device must accept any interference, including interference that may cause undesired operation of the device.

Le présent appareil est conforme aux CNR d'Industrie Canada applicables aux appareils radio exempts de licence. L'exploitation est autorisée aux deux conditions suivantes:

- (1) l'appareil ne doit pas produire de brouillage, et
- (2) l'utilisateur de l'appareil doit accepter tout brouillage radioélectrique subi, même si le brouillage est susceptible d'en compromettre le fonctionnement.

Radiation Exposure Statement:

Under ISED regulations, this radio transmitter may only operate using the antenna that is affixed to the radio transmitter. Use only the supplied antenna. Unauthorized antennas, modifications, or attachments could damage the transmitter and may void the user's authority to operate the radio.

Any changes of modifications not expressly approved by the party responsible for compliance could void the user's ability to operate the equipment.

SAR tests are conducted using standard operating positions accepted by the FCC/ISED with the device transmitting at its highest certified power level in all tested frequency bands.

Although the SAR is determined at the highest certified power level, the actual SAR level of the device while operating can be well below the maximum value.

This device has been tested and certified to not exceed the exposure limit established by the FCC/ISED. Tests for each device are performed in positions and locations (e.g. at the ear and worn on the body) as required by the FCC/ISED.

For body worn operation, this device has been tested and meets the FCC/ISED RF exposure guidelines when used with an accessory designated for this product or when used with an accessory that contains no metal and that positions the handset a minimum of 10mm from the body. Non-compliance with the above restrictions may result in a violation of RF exposure guidelines.

Appendix A. – Technical Specifications

General Part

Channels	30
Sub-Codes	50 CTCSS Tones/ 105 DCS Codes
Frequency Range	400-480MHz
Working temperature	-20°C to +50°C
Operation Voltage	DC 3.7 V ±10%
Operation Mode	Simplex

Transmitter Part

RF Output Power	2W
FM Modulation	11K0F3E@12.5KHz
Adjacent Channel Power	60dB @ 12.5KHz
Transmission current	≤1000mA

Receiver Part

Receive Sensitivity	0.25μV (12dB SINAD)
Adjacent Channel Selectivity	≥55dB@12.5KHz
Inter Modulation and Rejection	≥55dB@12.5KHz
Conducted Spurious Emission	≤-57dB@12.5KHz
Rated Audio Power Output	0.75W @8 ohms
Receive current	≤380mA
Rated Audio Distortion	≤5%

NOTE: All specifications may be modified without prior notice or liability.

Appendix B. – Trouble Shooting Guide

Phenomena	Analysis	Solution
You cannot turn on the radio.	The battery may be installed improperly.	Remove and reattach the battery.
	The battery power may run out.	Recharge or replace the battery.
	The battery may suffer from poor contact caused by dirty or damaged battery contacts.	Clean the battery contacts or replace the battery.
During receiving, the voice is weak or intermittent.	The battery voltage maybe low.	Recharge or replace the battery.
	The volume level may be low.	Increase the volume.
	The antenna maybe loose or maybe installed incorrectly.	Turnoff the radio, and then remove and reattach the antenna.
You cannot communicate with other group members.	The speaker maybe blocked.	Clean the surface of the speaker.
	The frequency or signaling type maybe inconsistent with that of other members.	Verify that your TX/RX frequency and signaling type are correct.
You hear unknown voices or noise.	You may be too far away from other members.	Move towards other members.
	You may be interrupted by radios using the same frequency.	Change the frequency, or adjust the squelch level.
You are unable to hear anyone because of too much noise and hiss.	The radio in analog mode maybe set with no signaling.	Request your dealer to set signaling for the current channel to avoid interference
	You may be too far away from other members.	Move towards other members.
	You may be in an unfavorable position. For example, your communication may be blocked by high buildings or blocked in an underground area.	Move to an open and flat area, restart the radio, and try again.
The radio keeps transmitting.	It may be the result of external disturbance (such as electromagnetic interference).	Stay away from equipment that may cause interference.
	VOX may be turned on or the headset is not installed in place	Turn off the VOX function. Check that the headphones are in place.

NOTE: If the above solutions cannot fix your problems, or you may have some other queries, please contact your dealer for more technical support.

| Care and Cleaning

To guarantee optimum performance as well as a long service life of the radio, follow the tips below.

1. Product Care

- Do not pierce or scrape the radio.
- Keep the radio far away from substances that can corrode the circuitry.
- Do not hold the radio by the earpiece cable.
- Close the accessory connector cover when no accessory is in use.

2. Product Cleaning

Turn off the radio and remove the battery before cleaning.

- Clean up the dust and fine particles on the radio surface with a clean and dry lint-free cloth or a brush regularly.
- Use neutral cleanser and a non-woven fabric to clean the keys, knobs, and front case after long-time use. Do not use chemical preparations such as stain removers, alcohol, sprays, or oil preparations, so as to avoid surface case damage.
- Make sure that the radio is completely dry before use.

ALERVITES